

made of grade 304 stainless steel - grade 316 on request

Inoxsystem® modular lines made to measure on request with connection flanges, reinforced edges, etc.

**Line 0810**

- Channel with grating
- Version without odor trap
- Direct outlet  $\varnothing$  63, h 100 mm
- See page 16 for more details

CHANNEL CROSS SECTION

Art. Inoxsystem® -CGS-...

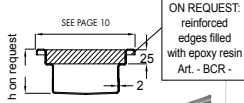

ON REQUEST:  
reinforced edges filled with epoxy resin  
Art. -BCR-



WITH HEELSAFE GRATING IDEAL FOR SWIMMING POOLS, SHOWERS AND TERRACES

CENTRAL VERTICAL OUTLET

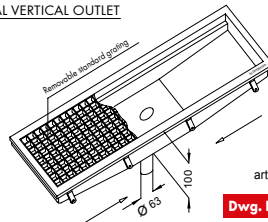

art. CGDV .....  
Dwg. No. 0812

CENTRAL HORIZONTAL OUTLET

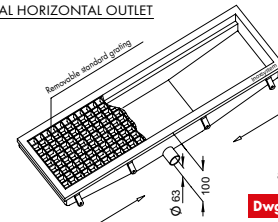

art. CGDO .....  
Dwg. No. 0814

END VERTICAL OUTLET

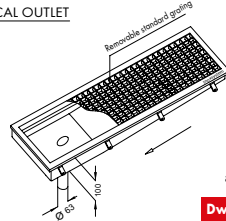

art. CGDVT .....  
Dwg. No. 0813

END HORIZONTAL OUTLET

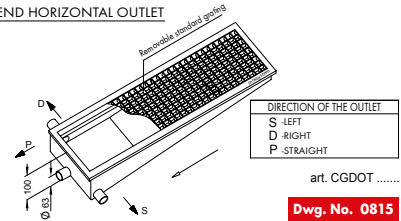

art. CGDOT .....  
Dwg. No. 0815

**Line 0460**

- "Hidden" slot channel to be installed under the floor
- Version with straight horizontal edges
- With direct outlet or odor trap,  $\varnothing$  63 mm, with inspection unit

INSTALLATION EXAMPLE

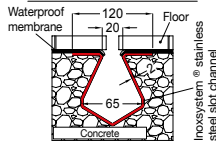

DEVELOPED FOR WATERPROOF MEMBRANE APPLICATION

CENTRAL VERTICAL OUTLET

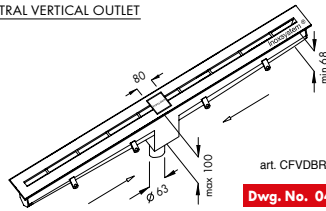

art. CFVDBRI .....  
Dwg. No. 0463

CENTRAL HORIZONTAL OUTLET

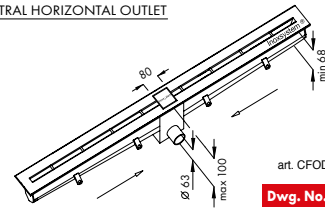

art. CFODBRI .....  
Dwg. No. 0461

END VERTICAL OUTLET

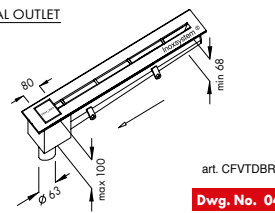

art. CFVTDBRI .....  
Dwg. No. 0464

END HORIZONTAL OUTLET

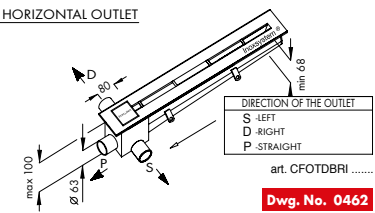

art. CFOTDBRI .....  
Dwg. No. 0462

**Line 0450**

- "Hidden" slot channel to be installed under the floor
- Version with straight horizontal edges
- Direct outlet  $\varnothing$  63 mm without inspection unit

INSTALLATION EXAMPLE

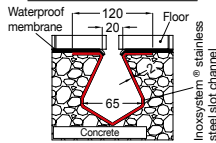

DEVELOPED FOR WATERPROOF MEMBRANE APPLICATION

CENTRAL VERTICAL OUTLET

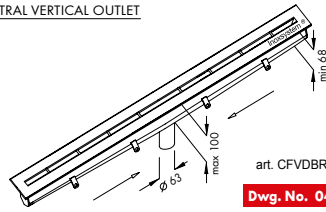

art. CFVDBR .....  
Dwg. No. 0453

CENTRAL HORIZONTAL OUTLET

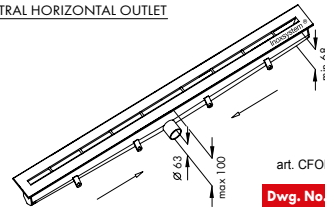

art. CFODBR .....  
Dwg. No. 0451

END VERTICAL OUTLET

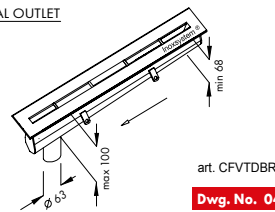

art. CFVTDBR .....  
Dwg. No. 0454

END HORIZONTAL OUTLET

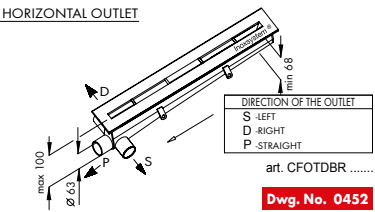

art. CFOTDBR .....  
Dwg. No. 0452

SINGLE-SLOT GRATING FOR CONCRETE TRENCH DRAINS



INSTALLATION EXAMPLE  
Stainless steel slot channel

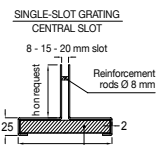
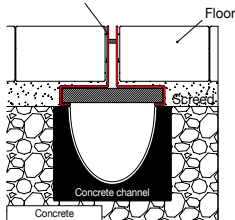

Article 4001 Dwg. No. 4001

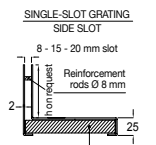

Article 4002 Dwg. No. 4002

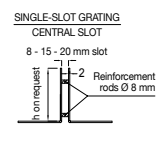

Article 4003 Dwg. No. 4003

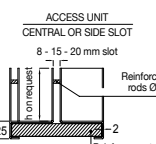

Article 4004 Dwg. No. 4004

STAINLESS STEEL GRATING FOR INSPECTION WITH FRAME

STANDARD GRATING Mesh 25x22 mm

HEAVY DUTY LADDER GRATING, BARS 25x8 mm



Article 0863 Dwg. No. 0863



Article 0861 Dwg. No. 0861



Article 0864 Dwg. No. 0864



Article 0865 Dwg. No. 0865

STAINLESS STEEL GRATING FOR INSPECTION WITH FRAME

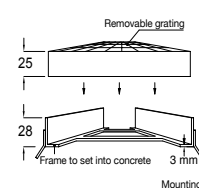

INSTALLATION EXAMPLE  
Stainless steel slot channel

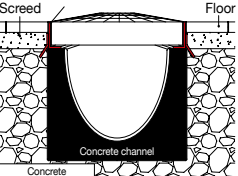

MADE TO MEASURE

www.inoxsystem.it