

made of grade 304 stainless steel - grade 316 on request

Flange for waterproof membrane application.

Dwg. 0935: CHANNEL WITH GRATING

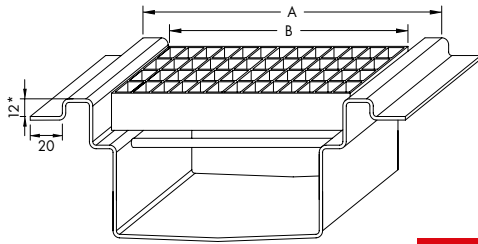

Dwg. No. 0935

| | |
|---------|----------|
| Article | CGS 0935 |
|---------|----------|

11 *If turnout dimension is 15 mm the grating height will be 30 mm
Flange suitable for channels at page 16

Dwg. 5025: Inoxsystem® Total Hygienic CHANNEL

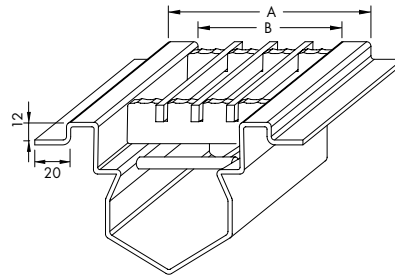

Dwg. No. 5025

| | | |
|------------|-----|----|
| Article | A | B |
| TH 100 BPG | 100 | 67 |

12 *For more information see page 49

Dwg. 2025: SLOT CHANNEL

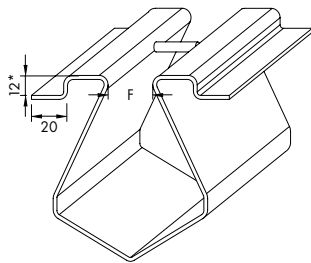

Dwg. No. 2025

| | |
|---------|------------|
| Article | F |
| C1 2025 | 8 mm slot |
| C2 2025 | 20 mm slot |

13 *Turndown dimension should be 15 mm on request
Flange suitable for channels at page 12

Dwg. 2011: HIDDEN SLOT CHANNEL

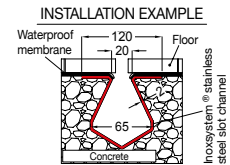
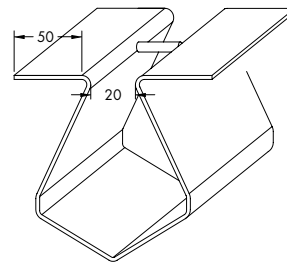

Dwg. No. 2011

| | |
|---------|--------|
| Article | C2 BDL |
|---------|--------|

6 To be installed under the floor. With straight horizontal edges
See page 35 lines 0450 and 0460

Inoxsystem® ITALIA IDrain LINEAR SHOWER DRAINS

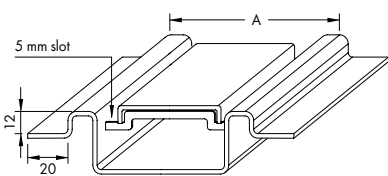

17 Dwg. No. 3025

| | |
|-----------|-----|
| Article | A |
| ID85 BPG | 85 |
| ID115 BPG | 115 |

*Turndown dimension should be 15 mm on request.
Flange suitable for Inoxsystem® Italia IDrain linear shower drains. Recommended for channels with regular depth.

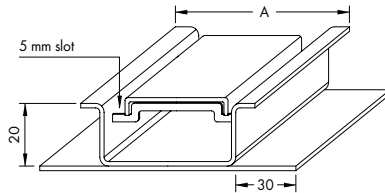

37 Dwg. No. 3028

| | |
|----------------|-----|
| Article | A |
| ID70 + IDP110 | 70 |
| ID100 + IDP140 | 100 |

Flange suitable for Inoxsystem® Italia IDrain linear shower drains. Recommended for channels with regular depth.

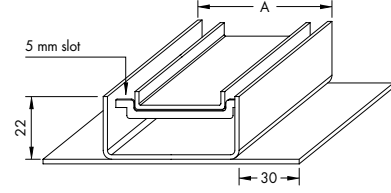

38 Dwg. No. 3029

| | |
|----------------|----|
| Article | A |
| ID54P + IDP110 | 54 |
| ID84P + IDP140 | 84 |

Flange suitable for Inoxsystem® Italia IDrain linear shower drains. Recommended for channels with regular depth.

INSTALLATION EXAMPLES

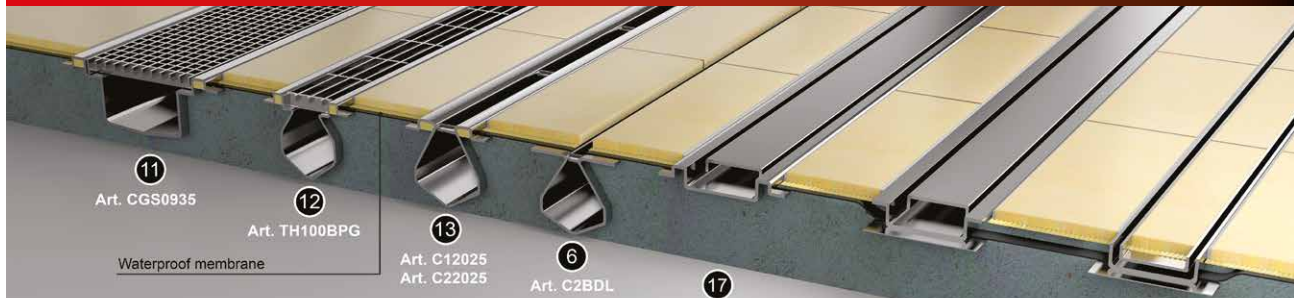

11 Art. CGS0935

12 Art. TH100BPG

13 Art. C12025
Art. C22025

6 Art. C2BDL

17 Art. ID85BPG
Art. ID115BPG

37 Art. ID70 + Art. IDP110
Art. ID100 + Art. IDP140

38 Art. ID54P + Art. IDP110
Art. ID84P + Art. IDP140

- 11 channel with grating with flange for waterproof membrane application
- 12 Inoxsystem® Total Hygienic channel with with flange for waterproof membrane application
- 13 slot channel with flange for waterproof membrane application
- 6 hidden slot channel with flange for waterproof membrane application
- 17 Inoxsystem® Italia IDrain linear shower drain with satin finished cover and flange for waterproof membrane application
- 37 Inoxsystem® Italia IDrain linear shower drain with satin finished cover and flange for waterproof membrane application
- 38 Inoxsystem® Italia IDrain linear shower drain with tileable cover and with flange for waterproof membrane application