

made in stainless steel AISI 304 - AISI 316 upon request

Stainless steel pipe union, **Inoxsystem's type (mexican pipe union)**

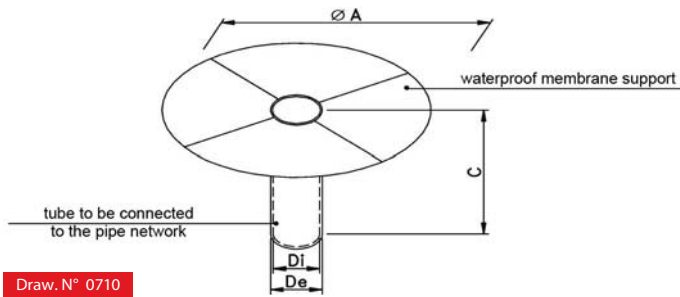

Draw. N° 0710

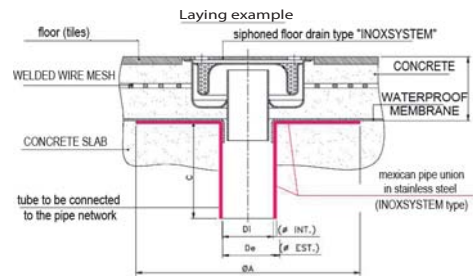

Article	MEASURE in mm				suitable for floor drain with max Ø outlet pipe
	Ø A*	De	Di	C	
M 50	330	50	45	300	suitable for Ø 40 outlet pipe
M 63	330	63	58	300	suitable for Ø 50 outlet pipe
M 75	330	75	70	300	suitable for Ø 63 outlet pipe
M 90	330	90	85	300	suitable for Ø 80 outlet pipe
M 110	330	109	104	300	suitable for Ø 90 outlet pipe
M 125	330	125	120	300	suitable for Ø 110 outlet pipe

*All measures can be modified upon request

Inspection floor drain **with closed bottom and connection channel**

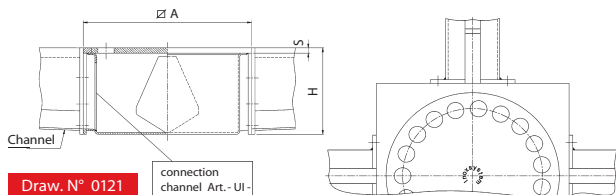

Draw. N° 0121

* = changeable values according to channel height

Article	MEASURE in mm			Capacity lt/min	Max. load in Kg	
	Ø A	S	H		LOAD CONCENT	LOAD DISTRIB
CC 80	80	3	*	*	1000	10000
CC 206	200	6	*	*	1000	10000
CC 258	250	8	*	*	1000	10000
CC 308	300	8	*	*	1000	10000



Accessories for channel **upon request**

Art. IL: **Setting up for internal channel washing with 1/2" pipe coupling on head and internal diffuser**

Art. BCR: **Reinforced channel edges, prefilled with rigid self clinging resin**

Art. PL: **Adjustable feet for level positioning**

Art. FLC: **Flanging for transport and installation of the slot channel**

Art. FLG: **Flanging for transport and installation of the grated channel**

Art. A90: **Welding and cutting on grated channel corner**

Art. A90G: **Welding and cutting on grated channel corner**



Inoxsystem® produces a **different type of top covers upon request**



Inoxsystem® plate "anti cut" standard RECOMMENDED



Customized Plate



Cowslip Plate



Blind Plate with tight "OR"



Lillium Plate



Daisy Plate



Sunflower Plate



Tulip Plate

N.B.: - All measures can be modified upon request.

- These drawings are property of INOXSYSTEM®. They cannot be used or copied without our formal permission.